

去上海看世博

Qù Shànghǎi kàn shìbó

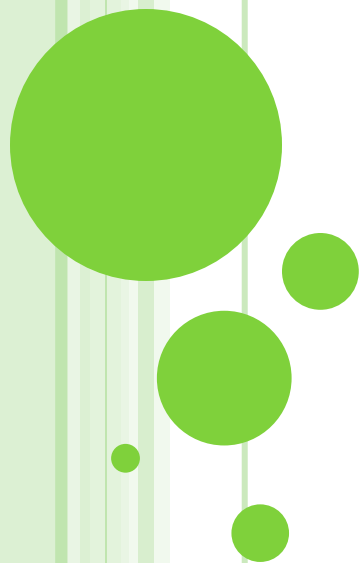
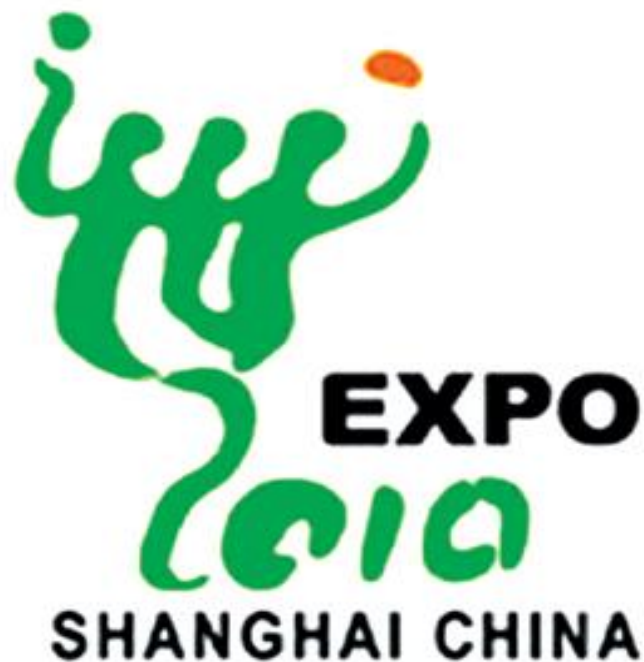

上课了，请起立。 Shàngkè le, qǐng qǐ lì.

老师好！同学们好！ Lǎoshī hǎo. Tóngxué men hǎo.

上课了，看老师。 Shàngkè le, kàn lǎoshī.

上课了，说中文。 Shàngkè le, shuō Zhōngwén.

听听，看看，说说，写写。 Tīngtīng, kànkàn, shuōshuō, xiěxiě.

浦东，浦西中文班， Pǔdōng, Pǔxī Zhōngwén bān

非常好！！ Fēi cháng hǎo!



你好歌

Nǐ hǎo gē



你好！你好！我很好！我很好！

Nǐhǎo! nǐhǎo! Wǒ hěn hǎo! Wǒhěn hǎo!

我们一起吃饭！我们一起吃饭！

Wǒmén yīqǐ chī fàn! Wǒmén yīqǐ chī fàn!

很快乐！很快乐！

Hěn kuàilè! Hěn kuài lè!



...先...然后...

...xiān...rán hòu...

○ 6:00

○ 先 xiān



○ 7:00

○ 然后 rán hòu



MISSION POSSIBLE 2010 IN SHANGHAI

去上海 看世博

Qù Shànghǎi kàn shìbó

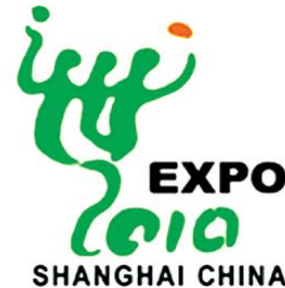

- You finally finish UVA STARTALK program and arrive Shanghai for 2010 Shanghai Expo!
 - Identify the different means of transportation
 - Know how to travel from one station to another
 - Visit the Expo and be able to identify each exhibition hall



车

chē



汽车

qì chē



公共汽车

gōnggòng qì chē



出租车

chū zū chē



地铁

dì tiě



飞机

fēi jī



A 比 B... (大/小/ 贵/便宜)
A bǐ B... (dà/xiǎo/guì/piányí)



坐

ZUÒ



坐公共汽车

zuò gōnggòng qìchē



坐出租车

zuò chū zū chē

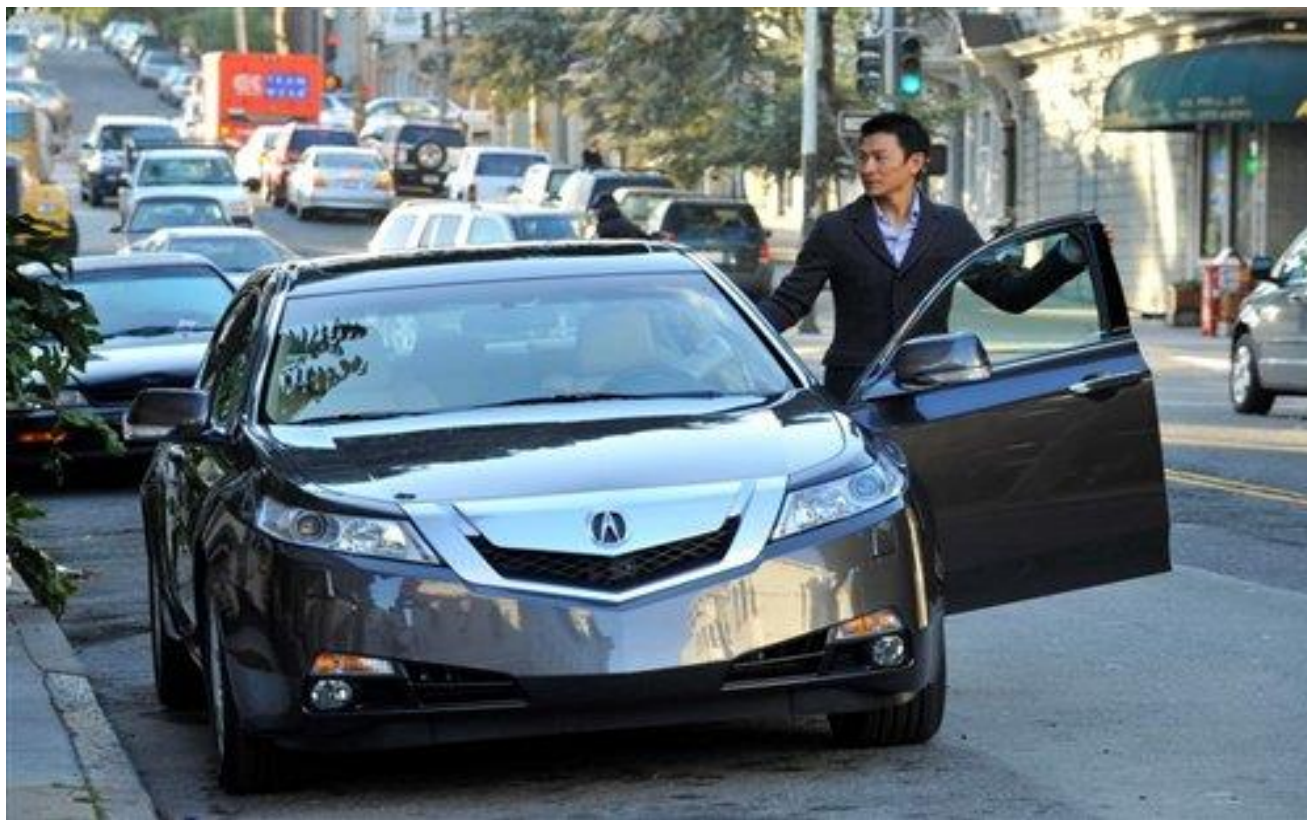

坐地铁

zuò dì tiě



坐飞机

zuò fēi jī



GROUP ACTIVITY

- You are divided into TWO groups.
- One group gives instruction and the other group do the action.



开车

kāi chē



走路

zǒu lù



自行车

Zì xíng chē



XGO汽车网 XGO.COM.CN

骑自行车

Qí zì xíngchē



Activity 你常常...吗?

Nǐ chángcháng... ma?

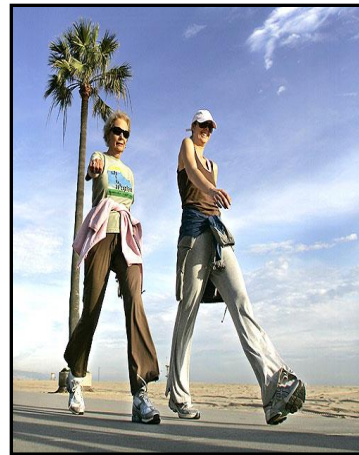

你怎么去...?
Nǐ zěnmē qù...?

我...去...
Wǒ...qù...



ACTIVITY

你怎么去...?
Nǐ zěnmē qù...?

我...去...
Wǒ...qù...

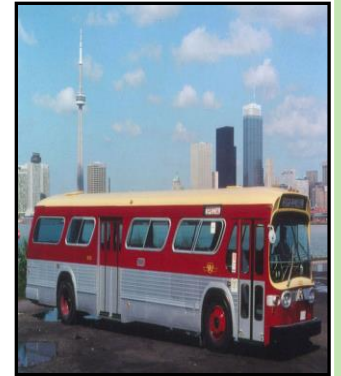
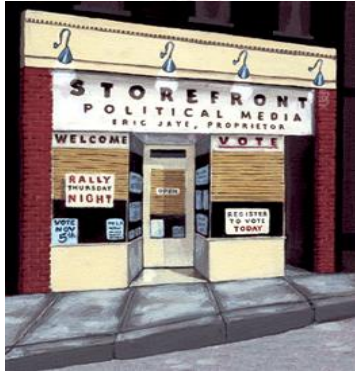

換

huàn



ACTIVITY

- You are going to be divided into TWO teams and compete with each other. Do what your teacher says and repeat what she says. (先坐...然后换.../xiān zuò... ránhòu huàn...)



东方明珠

Dōng fāng míng zhū



外滩

wàitān



中山公园

Zhōngshān gōngyuán

南京西路

Nánjīng xī lù



徐家匯
Xú jiā huì

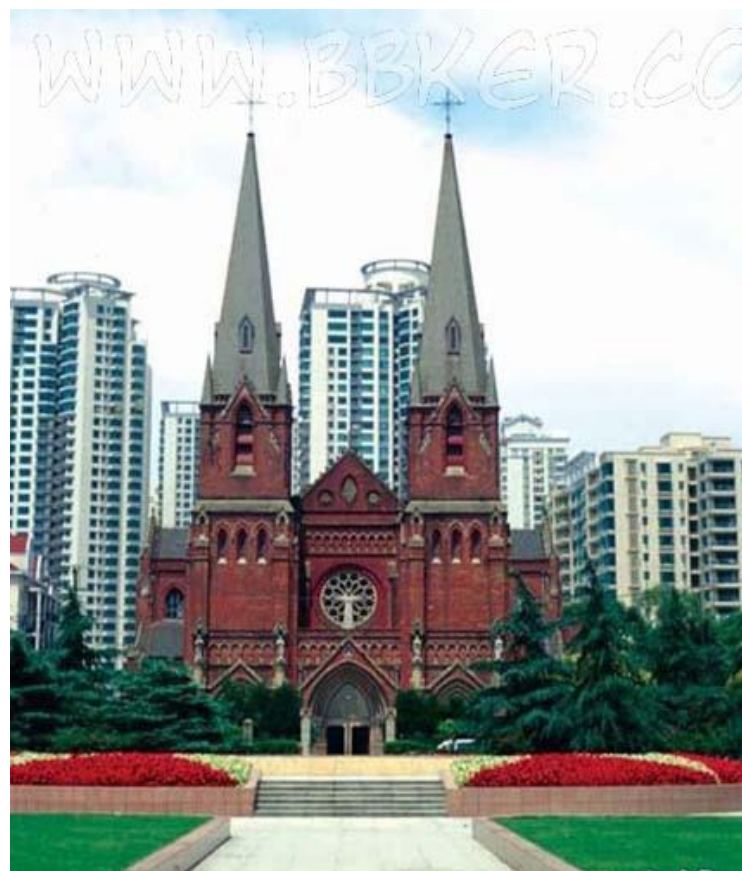

靜安寺
Jìng ān sì



先... 然后...

Xiān...ránhòu...



- Activity: You and your classmates are talking about what to do in shanghai.
- You can use the following structures:
- A:你想去哪儿? /Nǐ xiǎng qù nǎr?
- B:我想去...wǒ xiǎng qù...
- A:怎么去? /zěnmē qù?
- B: 先坐...然后换.../xiān zuò...ránhòu huàn...



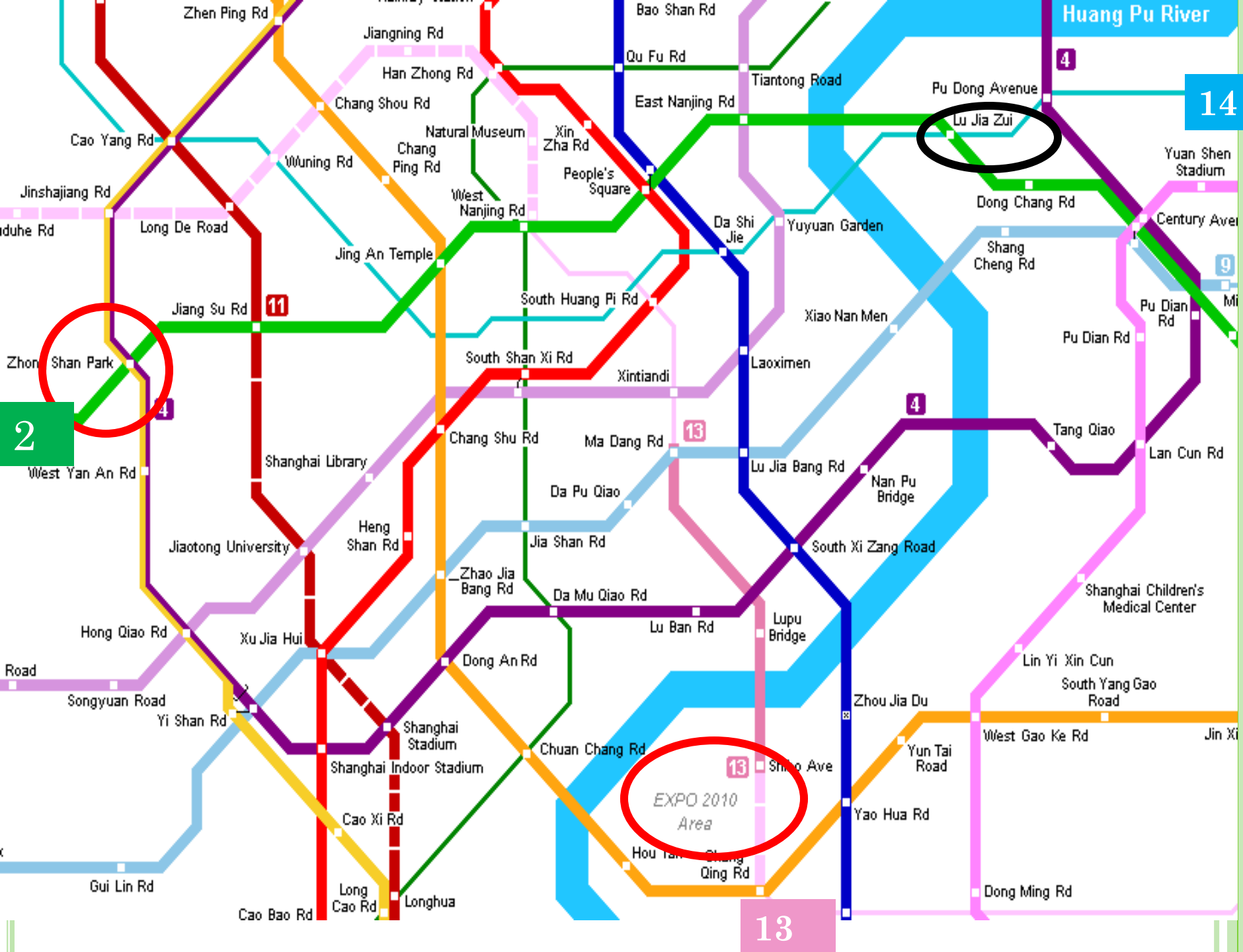

ACTIVITY: POINT AT ANY SPOT ON THE MAP AND ASK YOUR PARTNER HOW TO GET THERE BY SUBWAY.

○ E.g.

○ A:从中山公园到世博园，怎么去？

cóng zhōngshān gōngyuán dào shìbóyuán, zěnmē qù?

○

○ B: 先坐地铁2号线，然后换13号线。

○ Xiān zuò dìtiě èr hào xiàn, ránhòu huàn shí sān hào xiàn

○ 陆家嘴  世博园



TASK

- You want to go to Shanghai Expo. But you are at Shanghai somewhere and get lost. Now, you are calling your Chinese friend and ask him/her how you can get to Expo.

○ A: 喂，你好！

○ wéi, nǐ hǎo!

○ B: 喂，你好！

○ wéi, nǐ hǎo!

○ A: 你是...吗？

○ nǐ shì...ma?

○ B: 是，我是...

○ Shì, Wǒ shì...

○ A: 我是... 我要去上海世博。怎么去？

○ Wǒ shì... Wǒ yào qù... zěnmě qù ?

○ B: 先 坐。 。 。 再换。 。 。

○ Xiān zuò.....zài huàn...



方向

fāngxiàng





左边

zuǒbiān

右边

yòubiān

后边

hòubiān

前边

qiánbiān

上边

shàngbiān

下边

xiàbiān



运动操-前边, 在前边

cèsuǒ zài qiánbiān



网球
wǎngqiú

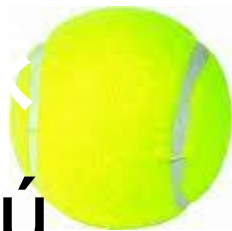

在 边
zài biān

棒球
bàngqiú



篮球
lánqiú



橄榄球
gǎnlǎnqiú

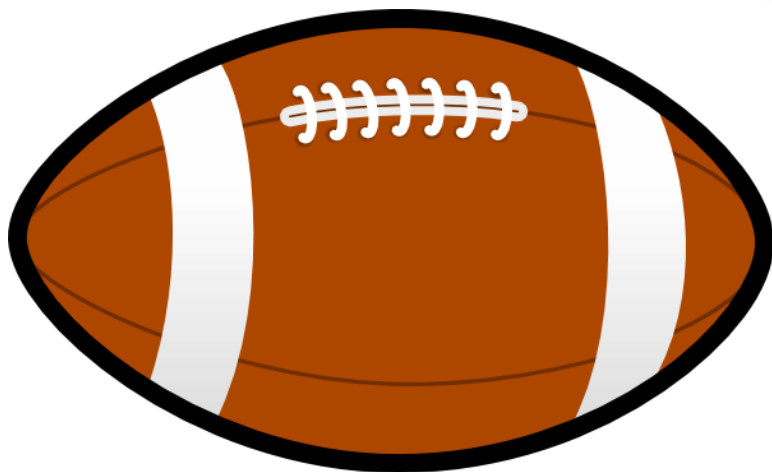

健身操- 厕所在前边



cèsuǒ zài qiánbiān

厕所在你的前边

○ cèsuǒ zài nǐ de qiánbiān

○ 厕所在哪儿？



PAIR ACITIVITIES

- Use the location words: 上面, 下面, 前边, 后边, 左边, 右边 to describe the class picture.

1. 柯安迪 在 右边。
KeAndi zài yòubiān



你在哪儿?
nǐ zài nǎr?



ACTIVITY: PAIR PRACTICE

柯安迪 在
KEANDI ZÀI

右边。
YÒUBIĀN

- Look at the class picture. First tell your partner where you are in the picture.
- Describe your classmates' location



健身操- 厕所在你的前边

cèsuǒ zài nǐ deqiánbiān



LOCATION EXERCISES 2 EXAMPLE:

2. 柯安迪 在 莫涵娜 的 右边。
KeAndi zài Mò Hán nà de yòubiān



ACTIVITY: PAIR PRACTICE

- 1. Look at the class picture. Tell your partner where you are, with reference .
- Describe your classmates' location, with reference.



EXPO PAVILIONS IN SHANGHAI



荷兰国家馆



挪威国家馆



芬兰国家馆



丹麦国家馆



新西兰国家馆



爱尔兰国家馆



德国国家馆



法国国家馆



西班牙国家馆



卢森堡国家馆



意大利国家馆



加拿大国家馆



澳大利亚国家馆



英国国家馆



尼泊尔国家馆



瑞士国家馆



中国

Zhōngguó



中国馆

Zhōngguó guǎn

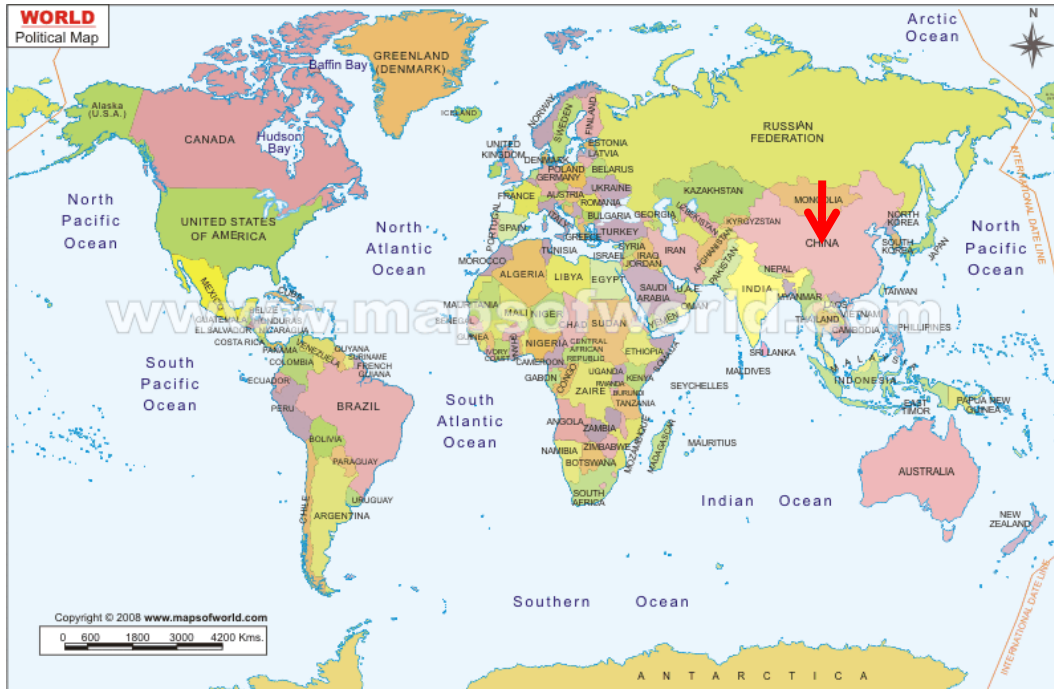

亚洲

Yàzhōu

亚洲馆

Yàzhōu guǎn



美洲

Měizhōu

美洲馆

Měizhōu guǎn



欧洲

Ōuzhōu

欧洲馆

Ōuzhōu guǎn

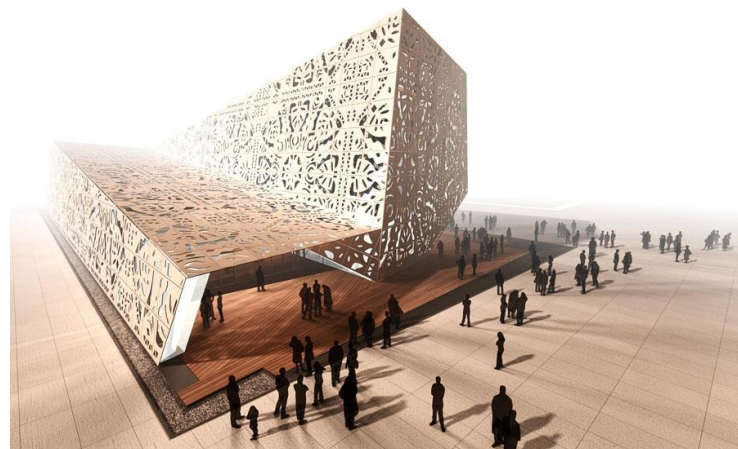

非洲

Fēizhōu

非洲馆

Fēizhōu guǎn



澳洲

Àozhōu

澳洲馆

Àozhōu guǎn



WORLD

Political Map



Copyright © 2008 www.mapsofworld.com

0 600 1800 3000 4200 Kms.

练习 LIÀNXÍ

1. Identify each continent with your partner.
2. Discuss with your partner. Guess what continent each of the following countries is in.
 - 中国 [Zhōngguó]
 - 美国 [Měiguó]
 - 英国 [Yīngguó]
 - 爱尔兰 [Àiěrlán]
 - 刚果 [Gāngguǒ]
 - 墨西哥 [Mòxīgē]





北边(běi biān)

○ 西边(xī biān)

东边(dōng biān)

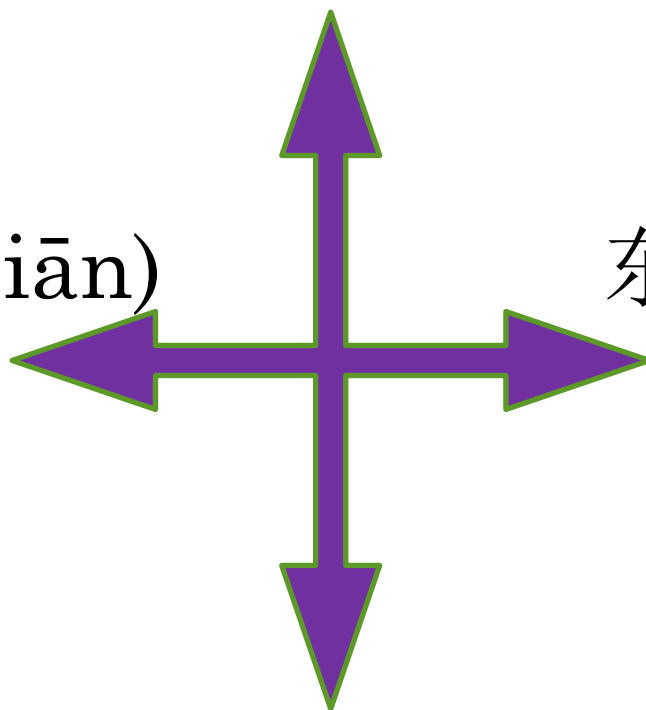

南边(nán biān)



- X: Place A 在哪儿?
 - (Place A)zài nǎr
- Y: 在..... 的北边 / 南边 /西边/东边
- (Place A)zài (Place B) de (běi biān) /(nán biān)。 。 。



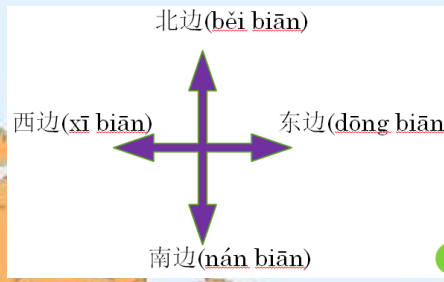

中国 在哪儿?
Zhōngguó zài nǎr?

中国 在美国的东边
Zhōngguó zài Měiguó de dōng biān

ACTIVITY- INFORMATION GAP

- You have got the Expo ticket. Now, look at the map on the handout. Get familiar with the map through discussion with your partner. You will take turns to ask each other where the following pavilions and facilities are, according to the sequence of the question numbers.

- 中国馆
- 欧洲馆
- 亚洲馆
- 美洲馆
- 非洲馆
- 地铁站(dìtiě zhàn)
- 商店(shāngdiàn)
- 厕所(cèsuǒ)



EXAMPLE

- X: 商店 在 哪儿？”
- Shāngdiàn zài nǎr? (Where is the shop?)
- Y: 商店 在 地铁站 的 西边
- Shāngdiàn zài dìtiě zhàn de xībiān
- The shop is at the west side of the subway station.

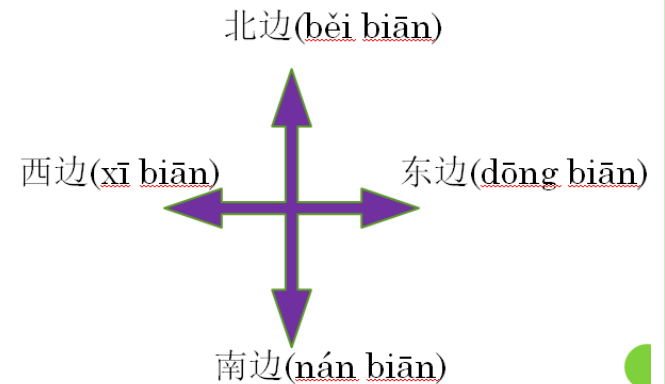

PAIR WORK:

DIALOGUE/SKIT PRESENTATION

- Create a dialogue regarding your Expo trip.
- Please include the following information in your skit:
 - Conversation regarding how to get to Expo Park. In your conversation, please
 - mention at least 2 transportation means.
 - use “...先...然后...”
 - Conversation regarding
 - Place A 在 Place B 的 ...边
 - Discussion regarding dinning at a restaurant

